

VELUX Skylights installed in new metal roofing

1. The sheets are fitted 100 mm from the bottom frame
2. The flashing is mounted
3. Fit the metal sheets
4. Skylights must be spaced 100mm apart for EKW centre channel to fit

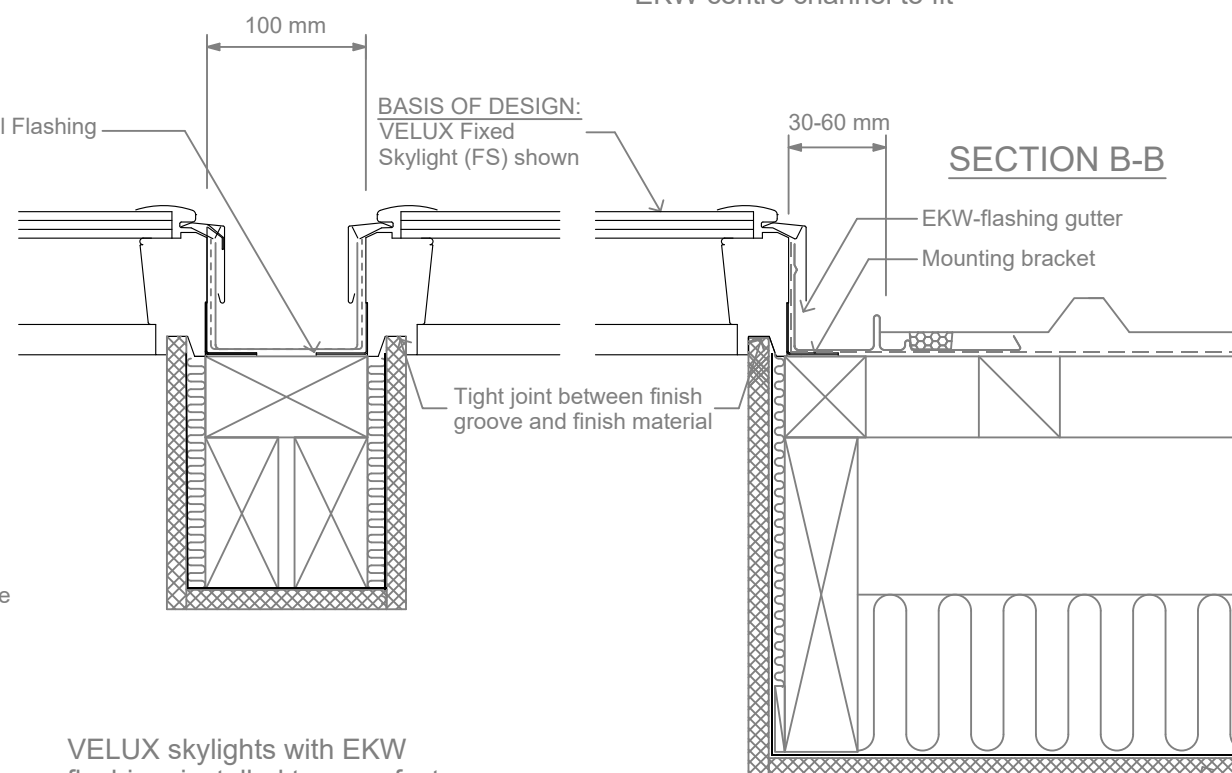

VELUX skylights with EKW flashing, installed to manufacturers installation instructions. Skylights must have a min. pitch of 15 degrees

VELUX Skylights and Side-by-side EKW Combi Flashing in Trapezoidal Metal Roof

VELUX
Sky-Product Management

NEW ZEALAND LTD.
0800 650 445

	Name	Date
Drawn by		Jan 18
Checked by		Jan 18
Drawing No.		

This drawing is an instrument of service and is provided for informational use only.

© 2011 VELUX GROUP

® VELUX is a registered trademark